

MAG. NORTH

SHEFF D. & ADA S. DLINGER

SHEFF D. & ADA S. DLINGER

JAMES M. BUSH

And Recorded
 Register Master
 Greenville County, S.C.

62, H.P. 79
 S.C.

3115
 7-C-38

NOTE
 THERE IS A 5' DRAINAGE & UTILITIES EASEMENT
 ALONG EACH SIDE AND REAR LOT LINES.

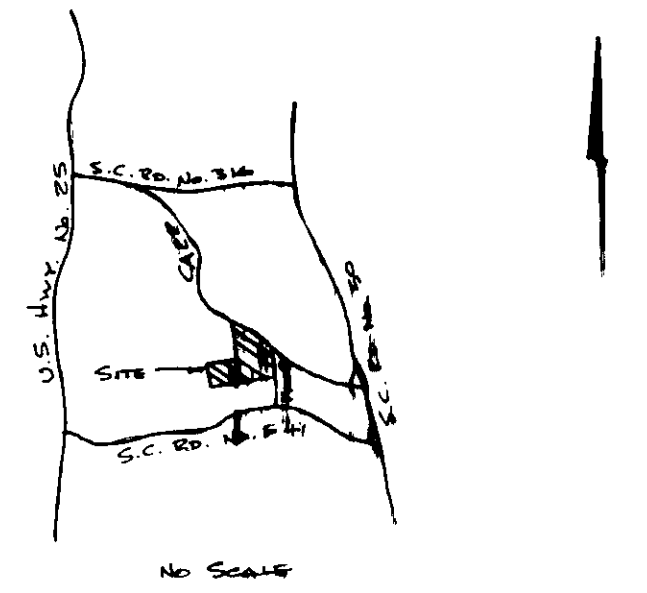

LOCATION MAP

FINAL PLAT

CERTIFICATE OF OWNERSHIP AND DEDICATION

The undersigned hereby acknowledge that I am (we are) the owner(s) of the property shown and described hereon and that I (we) hereby adopt this plan of subdivision with my (our) free consent and that I (we) establish the minimum building restriction lines, and hereby dedicate to public use as roads, streets, and easements, forever all areas so shown or indicated on said plat.

7-9-79 Signed Leroy Cannon
 7-9-79 Signed S.M. Ford
 7-9-79 Signed Gloria Ford
 - - - Signed

CERTIFICATE OF ACCURACY

I, Charles K. Dunn, certify that this plat was (drawn by me) (drawn under my supervision) (an actual survey made under my supervision) from an actual survey made by me (dead description recorded in Book Page Book Page etc) (other), that the error of closure as calculated by latitudes and departures is 1/75000 D.M. (that the boundaries not surveyed are shown as broken lines plotted from information found in Book Page that this plat was prepared in accordance with the Greenville County Subdivision Regulations as adopted.

JULY 6, 1979 DATE
 Charles K. Dunn LICENSED ENGINEER OR REGISTERED SURVEYOR

S. C. Registration No. 1712

CERTIFICATE OF APPROVAL FOR RECORDING

I hereby certify that the subdivision plat shown hereon has been found to comply with the Subdivision Regulations for Greenville County, with the exception of such variances, if any, as are noted in the minutes of the Greenville County Planning Commission of Greenville County, South Carolina, and that it has been approved for recording in the office of the County Register of Mense Conveyance.

July 30, 1979 DATE
 Director of Planning GREENVILLE COUNTY PLANNING COMMISSION

(19)-110-594.1-1-
 SUMMARY
 FILE NUMBER
 79-149

FINAL PLAT
 CARR ACRES
 SUMMARY PLAT.

CHARLES K. DUNN & T. CRAIG KEITH ASSOC. REG. L. S. NO. 1712 SURVEYOR
 LEROY CANNON, GLORIA F. AIKEN, & SAMUEL M. FORD OWNER

NO. OF ACRES: 11.63 MILES 0
 NO. OF LOTS: 5 DATE: JULY 6, 1979

